

NOTES:
 1. DUE TO OUR CONTINUOUS IMPROVEMENT PROGRAM, ALL MODELS AND SPECIFICATIONS ARE SUBJECT TO CHANGE WITHOUT NOTICE.

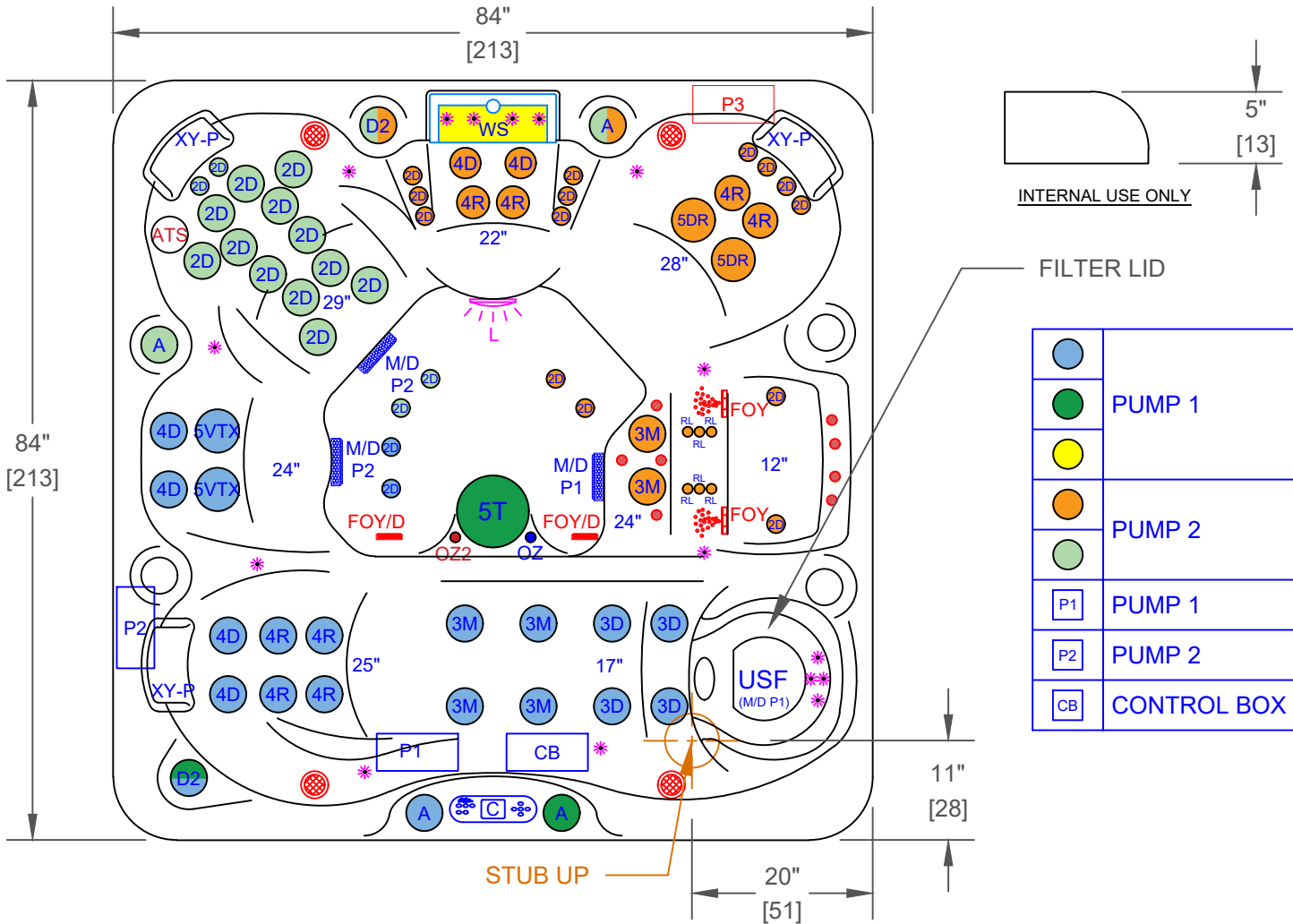

EC-767L - LEGEND			
SYMB.	DESCRIPTION	PART NUMBER	QTY.
RL	RAIN JET 1-1/4"	PLU670-2701S SGMS	6
2D	2" CLUSTER STORM DIRECTIONAL VECTOR X	PLUCS2440019S-HLG	32
3D	3" MINI STORM DIRECTIONAL VECTOR X	PLUCS2445009SS-HLG	4
3M	3" MINI STORM MASSAGE DIRECTIONAL VECTOR X	PLUCS2445059S-HLG	6
4D	4.5" POLY STORM DIRECTIONAL VECTOR X	PLUCS244609SS-HLG	6
4R	4.5" POLY STORM ROTO VECTOR X	PLUCS2446039S-HLG	8
5DR	5" POWER STORM TWISTER VECTOR X	PLUCS2447049SS-HLG	2
5VTX	5" POWER STORM TRI DIRECTIONAL VECTOR X	PLUCS2447019S-HLG	2
5T	5" ADJUSTABLE WHIRLPOOL VECTOR X WITH VALVE	PLUCS2394029S-HLG	1
D2	ORION 2" WATER DIVERTER VALVE	PLUCS800-7609-CDHL	2
A	ORION AIR CONTROL VALVE	PLUCS860-7609-CDHL	4
WS	12" LED WATERFALL SPILLWAY W/ VALVE	675-5308-HLGL	1
USF	75 SQ. FT. ULTRA SKIM FILTER	517-4619LC-HLG	1
M/D	MAIN DRAIN	PLU644-5416-HLG V	3
XY-P	TEXTURED Y-PILLOW (WHITE)		3
C	TP700		1
OZ	PURE SILK OZONATOR WITH MAZZIE INJECTOR AND MIXING CHAMBER		1
L	5" MULTI COLORED LED LIGHT		1
*	PERIMETER LED LIGHTING		1
-	FILTER LID (SINGLE FLT)	FIL11300260	1

OPTIONS		
SYMB.	DESCRIPTION	OPTION NUMBER
ATS	EXCLUSIVE ADJUSTABLE THERAPY SYSTEM PLUS (ATS PLUS)	OPT25-109
P3	ADDITIONAL 3RD PUMP 1 X 6 BHP (OPTION WILL UPGRADE CONTROL BOX TO BP501X)	OPT25-138B-3P N/A WITH ATS OR 24/7
-	COOLER SEAT UPGRADE (INCLUDES BLOWER + 8 AIR JETS)	OPT25-107CRS
OZ2	TWIN PURE SILK SYSTEM DIAL OZONATORS WITH MAZZIE INJECTORS AND MIXING CHAMBERS	OPT25-102DX-1
CS	CAL SPAS SALT SYSTEM	OPT25-113S
-	PURE CURE UV PURIFICATION SYSTEM	OPT25-191B
FOY	FOUNTAIN OF YOUTH SYSTEM	OPT25-FOY
24/7	24/7 FILTRATION SYSTEM	OPT25-112C
-	ABS MOLDED BOTTOM TRAY	OPT25-990-7
-	CAL CONNECT RF MODULE	OPT25-168RF
-	ELITE HORIZONTAL CABINET PANELS AND BLACK BEAM CORNERS (COLORS: GREY, MOCHA, LIME OAK)	OPT25-E981
FS	FREEDOM SOUND SYSTEM BLUETOOTH, POWERED SUBWOOFER AND 4X SPEAKERS	OPT25-FS43
-	THERMO-GUARD FULL FOAM *THIS OPTION WILL REPLACE THERMO-SHIELD	OPT25-900

SPECIFICATIONS		TITLE
DIMENSION (in)	84"x84"x40-1/2"	LINE
DIMENSION (cm)	213x213x100	MODEL
DRY WEIGHT	800 LBS [363 Kg]	NUM
FILLED WEIGHT	4340 LBS [1969 Kg]	DWG NO.
WATER CAP.	425 GAL [1609 L]	SCALE
		NTS
		SHEET 1 OF 1
		REV A
		CS003333
		JET LAYOUT - STD
		ESCAPE
		2025 SPA LINE COSTA
		EC-767L
		142 EAST NINTH STREET, POMONA, CA 91766
		CAL SPAS INC.
		PROPRIETARY AND CONFIDENTIAL
		THE INFORMATION CONTAINED IN THIS DRAWING IS THE SOLE PROPERTY OF CAL SPAS. ANY REPRODUCTION IN PART OR AS A WHOLE WITHOUT THE WRITTEN PERMISSION OF CAL SPAS IS PROHIBITED.